



September 10, 2012

## Liquidated Damages for Palm Bay Elementary Portable Relocation Project

Time is of the essence in the performance of the work under the Contract Documents. The Owner and Design/Builder agree that the losses suffered by the Owner, if Substantial Completion of the Work is not achieved, are not ascertainable at this time. Design/Builder acknowledges and agrees that, since time is of the essence, the Owner will suffer financial and other losses if the Substantial Completion of the Work is not achieved within the Contract Time as said Contract Time may be adjusted pursuant to the terms of the Contract Documents.

Substantial Completion: Design-Builder shall pay Owner \$250.00 as liquidated damages for each day that Substantial Completion extends beyond the Substantial Completion date.

Substantial Completion Date: 10/19/12

Final Completion: Design-Builder shall pay Owner \$500.00 as liquidated damages for each day that Final Completion extends beyond the Final Completion date.

Final Completion Date: 10/24/12

Contractor: CANAVERAL CONSTRUCTION CO. INC. [Signature]

Owner: \_\_\_\_\_

Owner: Brevard County School Board  
 Contractor: Canaveral Construction Co. Inc.

SSBC Portable Relocation Project  
 Palm Bay Elementary School

Submitted By: \_\_\_\_\_  
 Date: \_\_\_\_\_

ID	Task Name	Duration	Start	Finish	'12	Sep 9	'12	Sep 16	'12	Sep 23	'12	Sep 30	'12	Oct 7	'12	Oct 14	'12	Oct 21	'12		
					T	S	M	W	F	S	T	S	M	W	F	S	T	S	M	W	F
1	<b>PORTABLE RELOCATION</b>	33 days	Mon 9/10/12	Wed 10/24/12																	
2	Design and Permit for Five Portables	5 days	Mon 9/10/12	Fri 9/14/12																	
3	Locales	1 day	Mon 9/17/12	Mon 9/17/12																	
4	Disconnect all Utility Services	2 days	Mon 9/17/12	Tue 9/18/12																	
5	Ramp Removal	2 days	Wed 9/19/12	Thu 9/20/12																	
6	Tie Down Anchor and Skirting Removal	2 days	Fri 9/21/12	Mon 9/24/12																	
7	Prep to Haul	3 days	Tue 9/25/12	Thu 9/27/12																	
8	Transport Portables to New Location	5 days	Fri 9/28/12	Thu 10/4/12																	
9	Gate and Fence Removal and Reinstall	2 days	Fri 9/28/12	Mon 10/1/12																	
10	Sidewalk Demo & Site Restore	2 days	Fri 10/5/12	Mon 10/8/12																	
11	Set up Portables & Tie Down	3 days	Fri 10/5/12	Tue 10/9/12																	
12	Install New Utility Services	5 days	Wed 10/10/12	Tue 10/16/12																	
13	Install Ramps, Handrails, & Skirting	4 days	Wed 10/10/12	Mon 10/15/12																	
14	Install New Sidewalks	4 days	Tue 10/16/12	Fri 10/19/12																	
15	Final SBBC Inspection	1 day	Mon 10/22/12	Mon 10/22/12																	
16	Final Clean-up & Punchout	2 days	Tue 10/23/12	Wed 10/24/12																	

Project: 1208 - Scheduler rev1  
 Date: Mon 9/10/12

Task Split Progress

Milestone Summary Project Summary

External Tasks External Milestone Deadline

GRASS FIELD

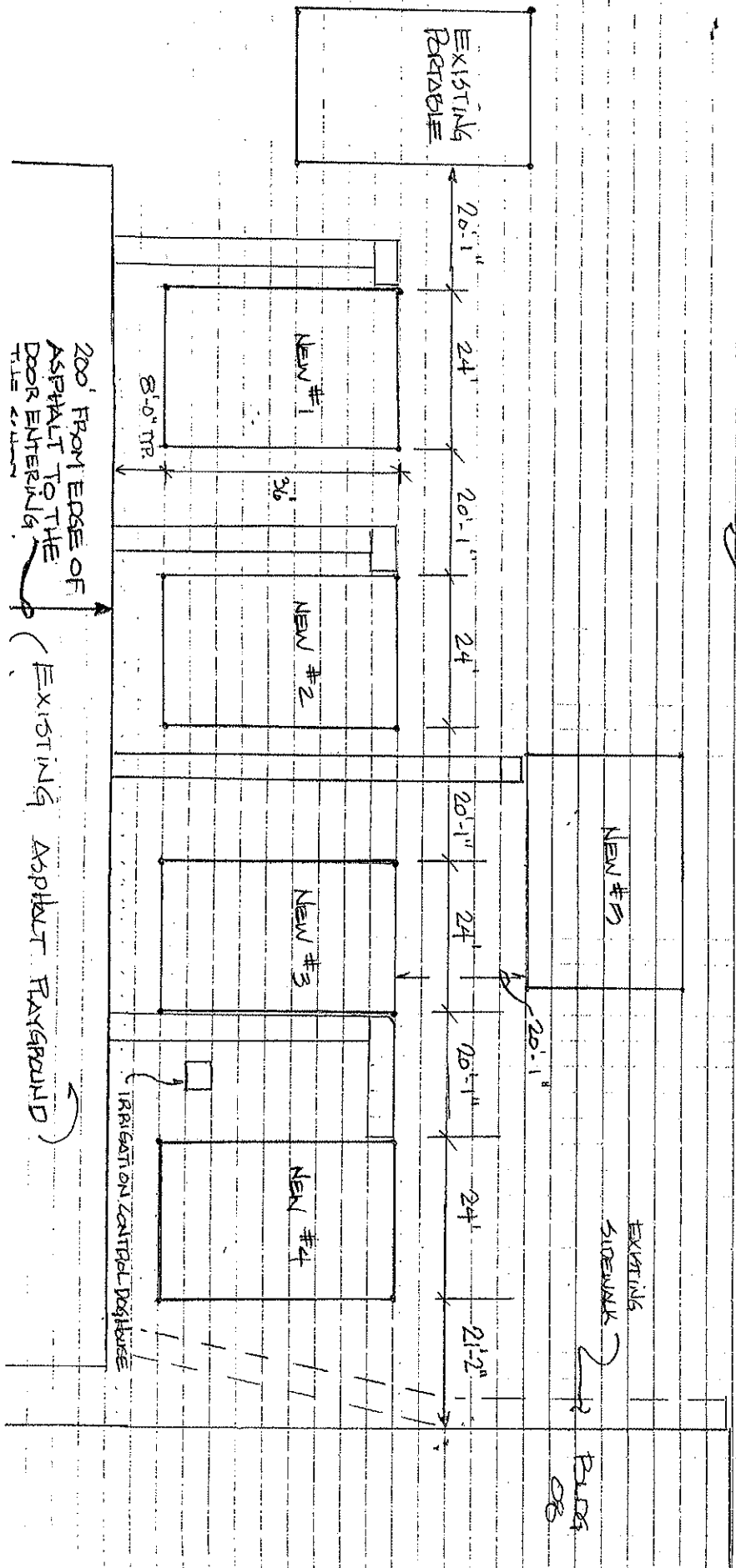

200' FROM EDGE OF ASPHALT TO THE DOOR ENTERING THE BUILDING

EXISTING ASPHALT PLAYGROUND

IRRIGATION CONTROL BOX

NEW #5

EXISTING SIDEWALK

BUDG OR